

SFN 2024 Prairie B

HS-39

58x77x16

Council
Meeting

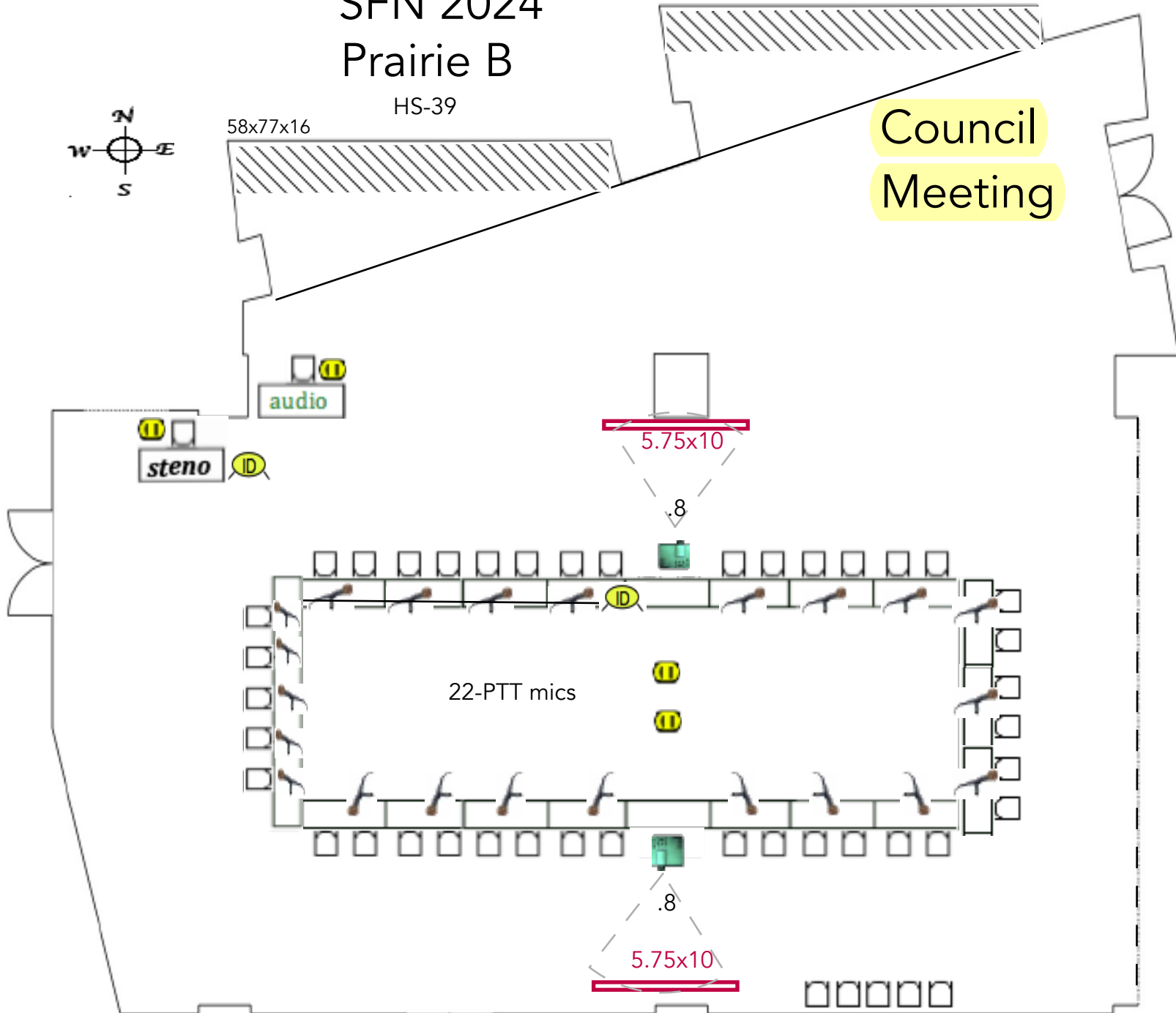
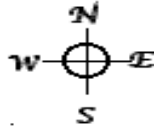

Audio: PPT tbl (22)
Skirted Tables: Conference 22 6'x24", 1
8'x24" (steno) & 1 8'x24"(Audio)

- Electric Drops
- Internet Drops

SFN 2024 Regency AB Program Cmte. Mtg.

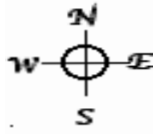

Lights: Preset lights off over screens
 Main Stage: 24'x8'x24" with rails and stairs
 Staff Riser: 18'x8'x24" with stairs
 Skirted Tables 36-6'x30" Stg.3-6'x30" Staff
 Riser 3-6'x30" Audio&AvTech 2-6'x30"

Foyer

- 6-120v electrical drops
- Internet Drops

58' x 105' x 18'

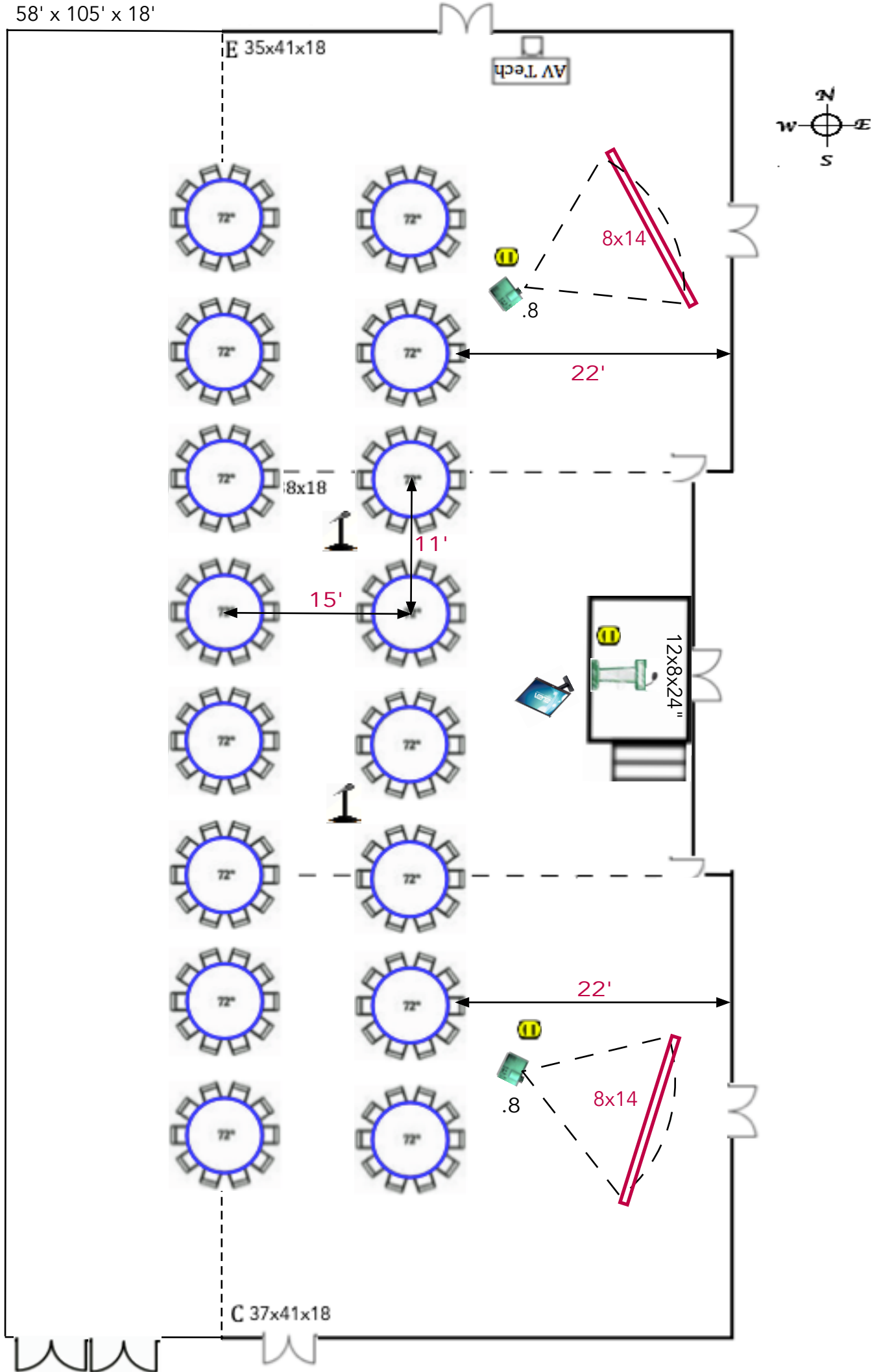

Audio: Lectern mic, tbl mics 4, Aisle/Floor mics(2)

Audio DI for computer playback

Video: (1) Confidence monitor

Platforms: Stage 12' x 8' x 24" with steps and railing

tables skirted:(16)72" round tables with 10 seats, (1)6'x24"(AV-Tech)

lights : preset room lights out over screen

Electric : 3-110V,20amp (2-Proj / stg.)

Regency C,D,E & Corridor

58' x 105' x 18'

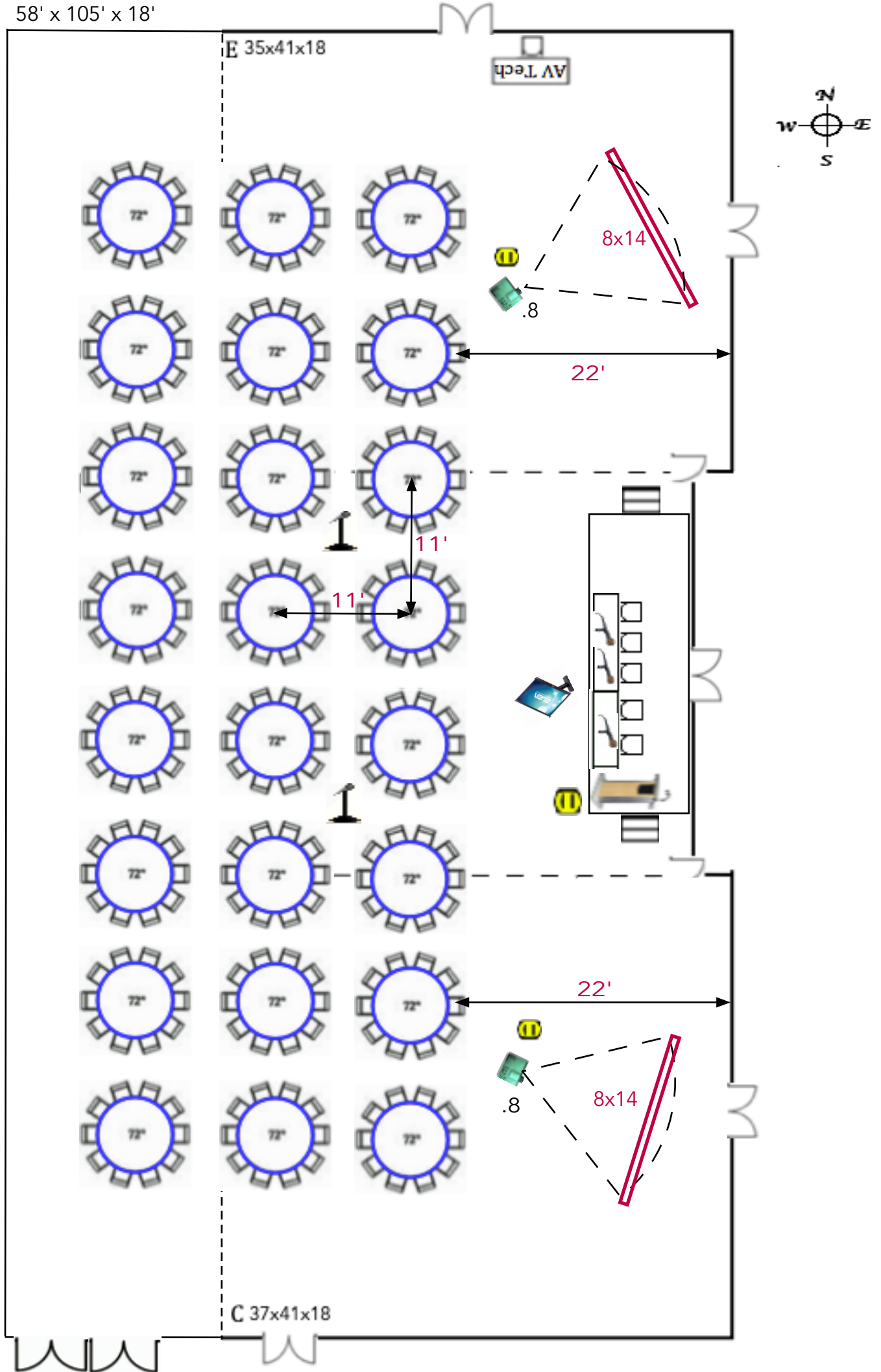

Audio: Lectern mic, tbl mics 4, Aisle/Floor mics(2)

Audio DI for computer playback

Video: (1) Confidence monitor

Platforms: Stage 24' x 8' x 24" with steps and railing

tables skirted: (1)6'x24" (2) 8'x24" (stage), (24)72" round tables with 10 seats, (1)6'x24"(AV-Tech)

Ⓛ lights : preset room lights out over screen

Electric : 3-110V,20amp (2-Proj / stg.)