



**NEUROSCIENCE
2024**

McCormick Place

Floor Plans

- SfN Booth

As of: 9/25/24

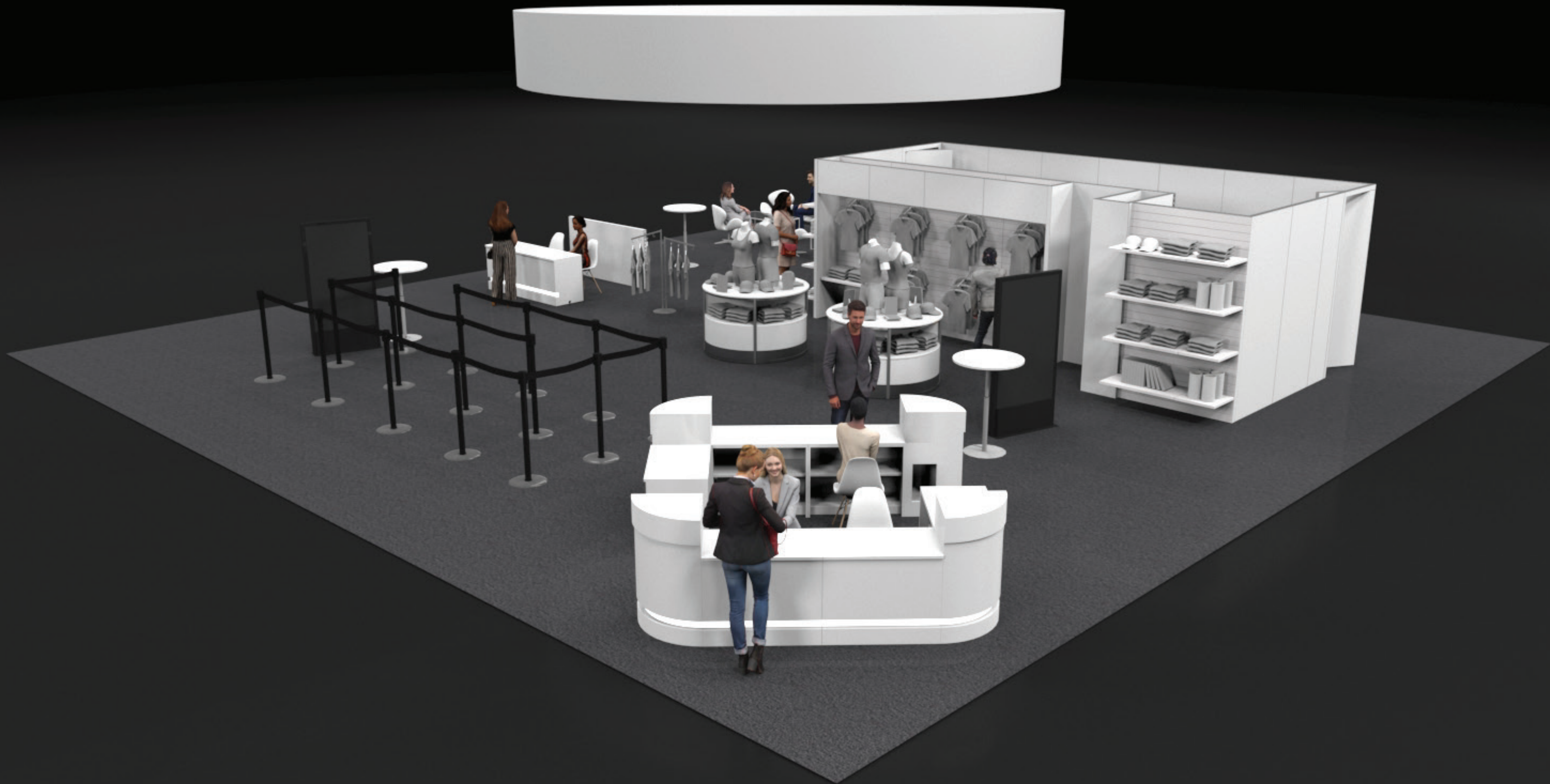

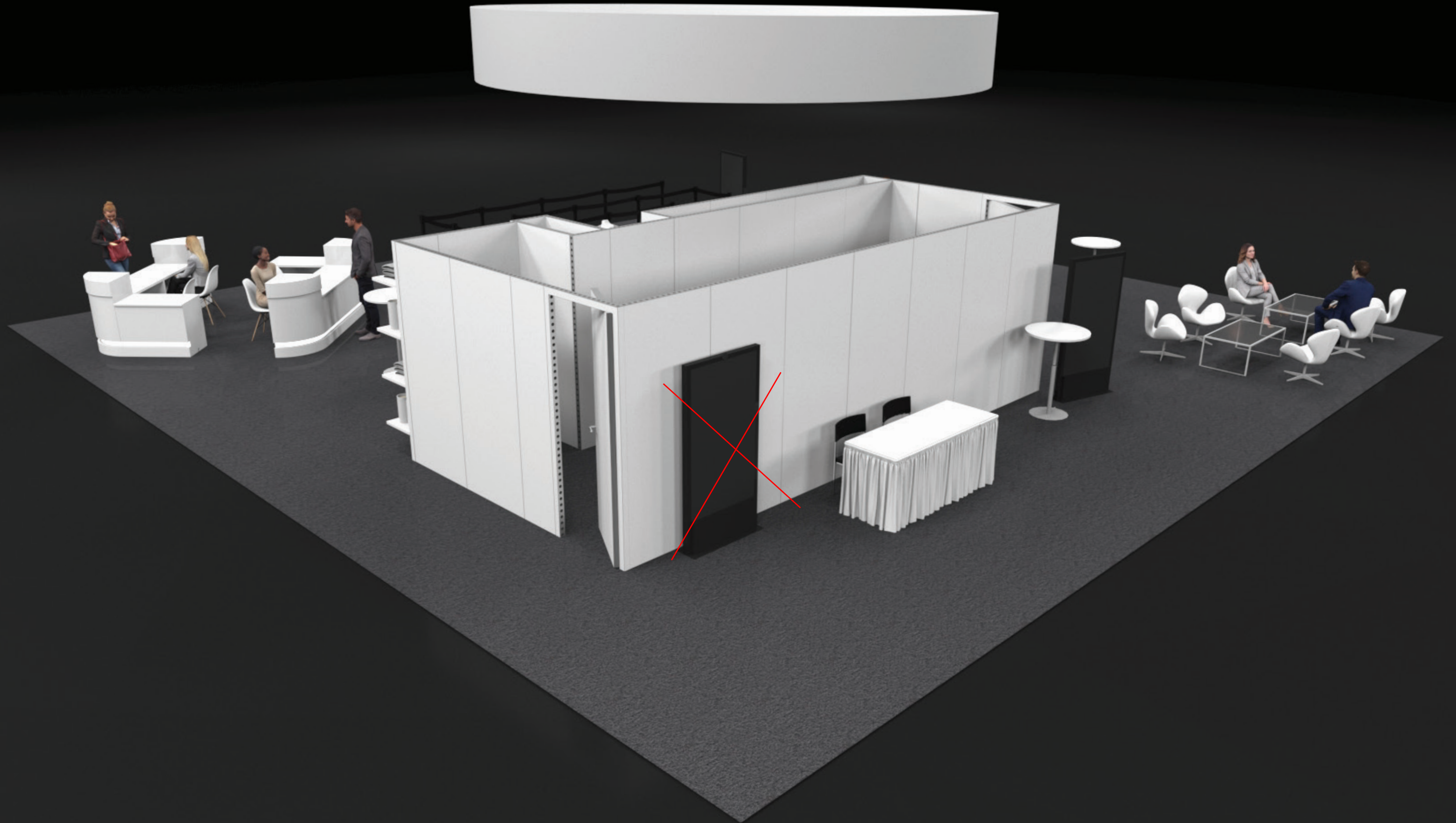

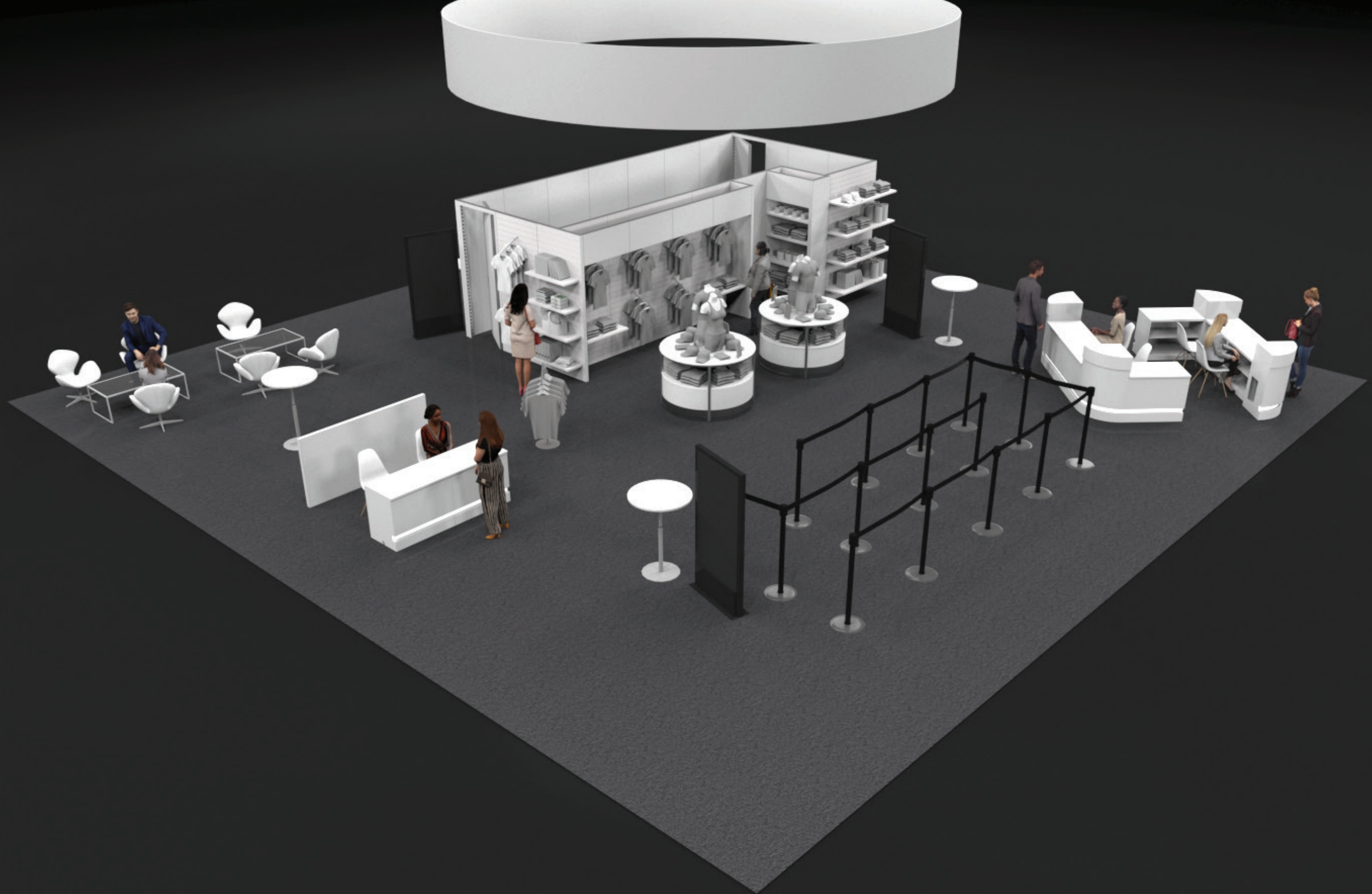

Meet The Editors

Journals

Wall 78" W x 39" H

Store Check Out Counter

Journal Bins (2)

SFN Staff

SFN Store

Delete this sign

Literature Racks (4) along wall

Enclosed Counters (to accommodate 4)

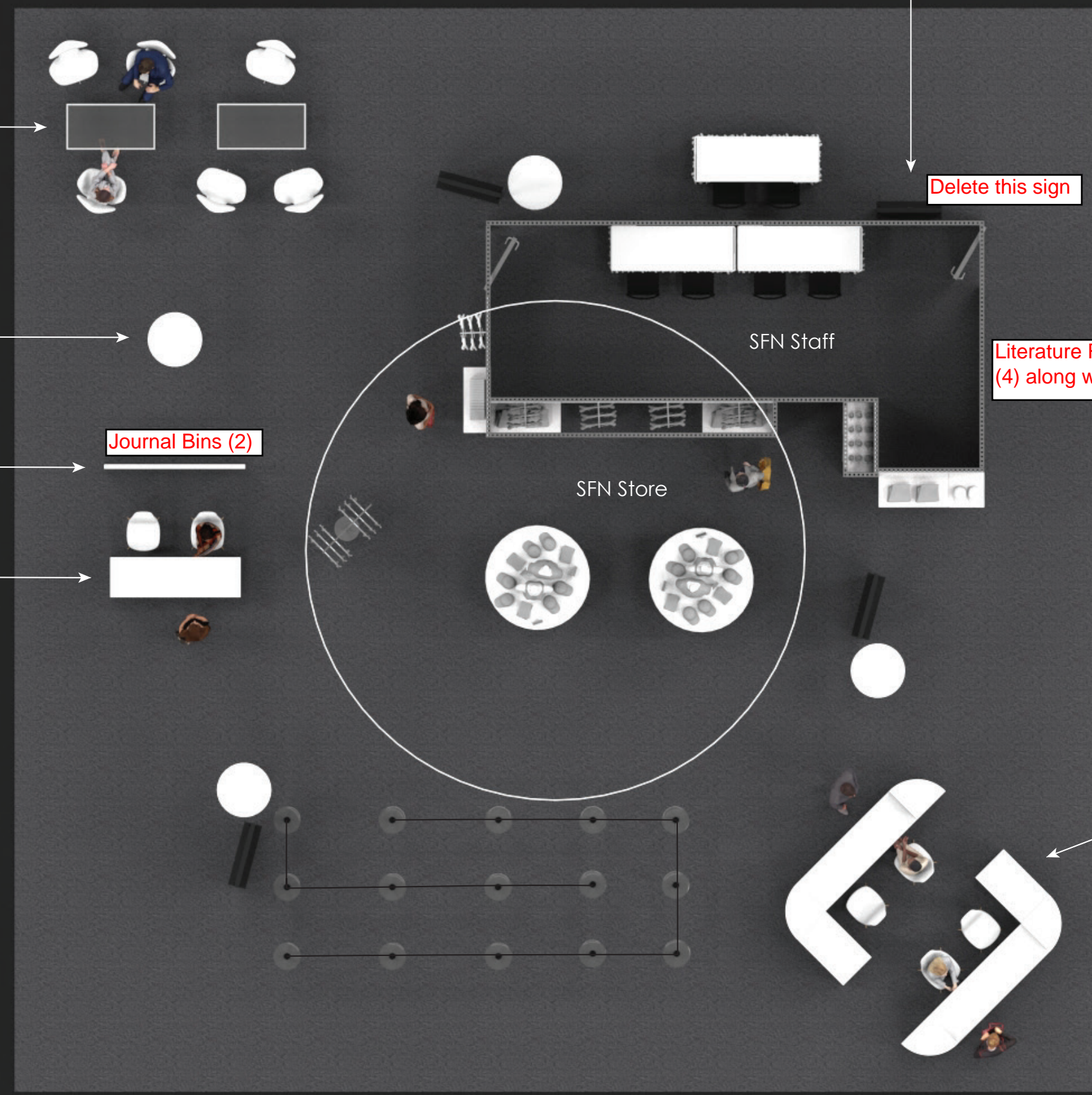

Delete this sign

SFN VENDOR DIGITAL SIGNAGE

(4) 90 DEGREE LAMINATE CTS
(2) 3' LAMINATE ADA COUNTERS
(2) 6' LAMINATE ADA COUNTERS

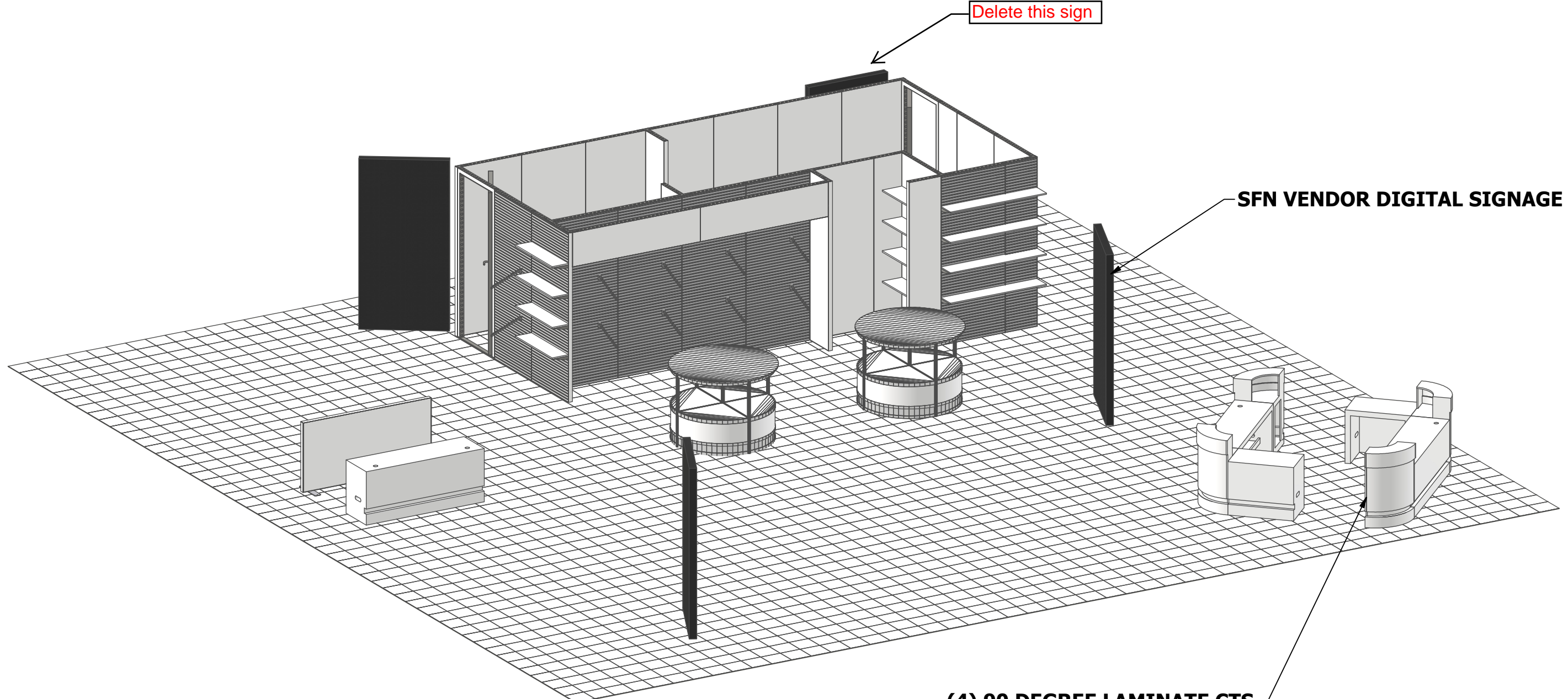

THE EXPO GROUP

PM:	Chris Balak	Date:	5-16-24
Drawn by:	Tom Palladino		
Client:	Neuroscience, 2024		
Project:	SHOW MGT BTH_V2		
Project #	2410003		
Description:	Assembly with floor		

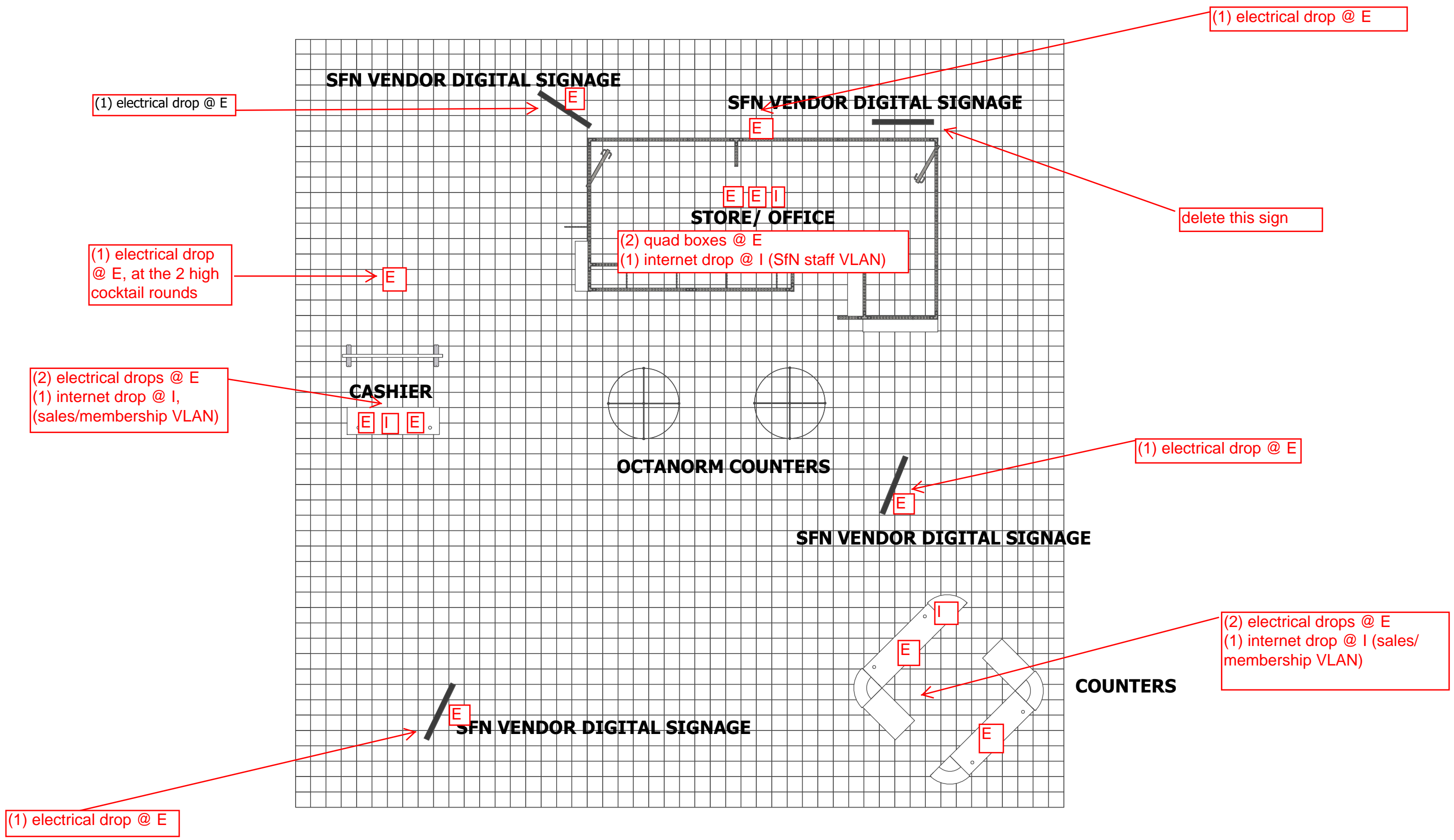

THE EXPO GROUP

PM:	Chris Balak	Date:	5-16-24
Drawn by:	Tom Palladino		
Client:	Neuroscience, 2024		
Project:	SHOW MGT BTH_V2		
Project #	2410003		
Description:	Assembly with floor		2 / 2

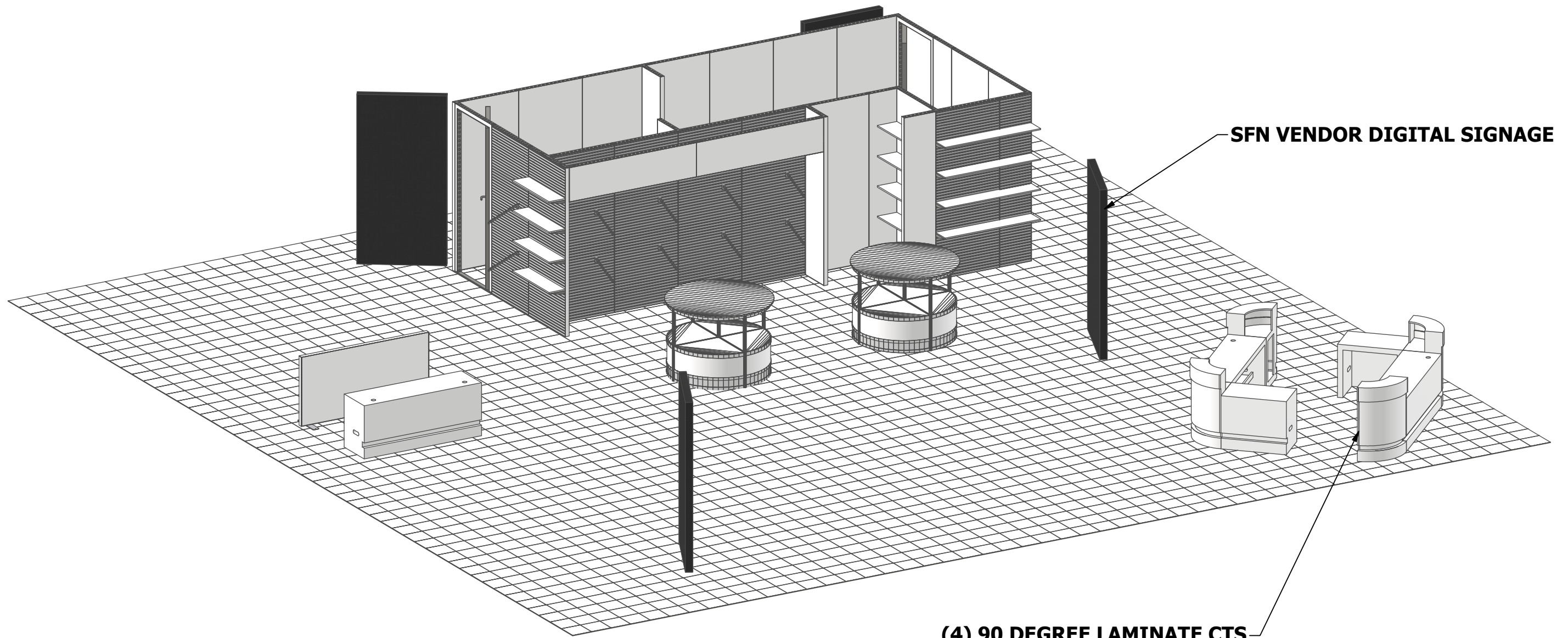

SFN VENDOR DIGITAL SIGNAGE

**(4) 90 DEGREE LAMINATE CTS
(2) 3' LAMINATE ADA COUNTERS
(2) 6' LAMINATE ADA COUNTERS**

THE EXPO GROUP

PM:	Chris Balak	Date:	5-16-24
Drawn by:	Tom Palladino		
Client:	Neuroscience, 2024		
Project:	SHOW MGT BTH_V2		
Project #	2410003		
Description:	Assembly with floor		

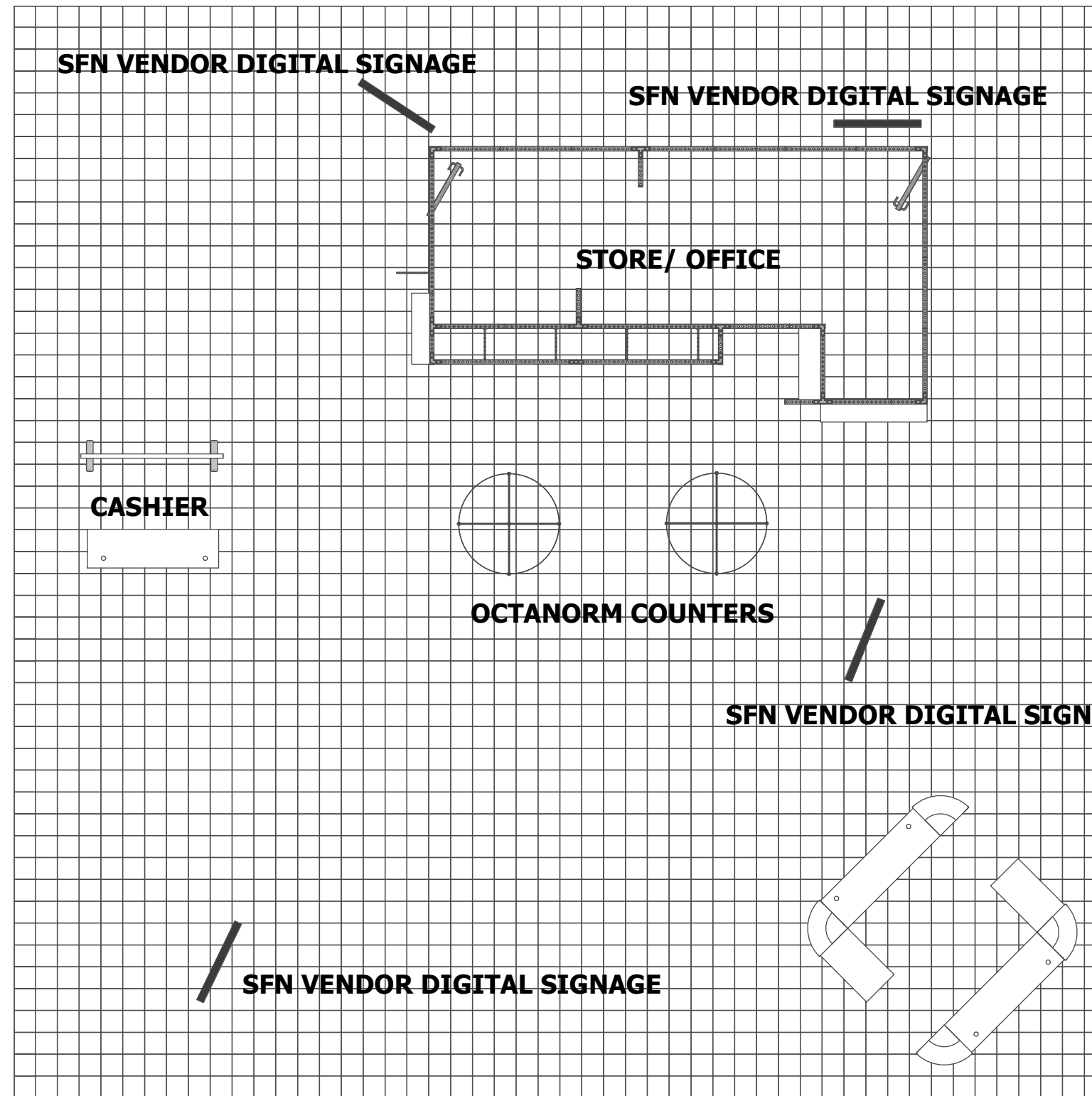

PM:	Chris Balak	Date:	5-16-24
Drawn by:	Tom Palladino		
Client:	Neuroscience, 2024		
Project:	SHOW MGT BTH_V2		
Project #	2410003		
Description:	Assembly with floor		

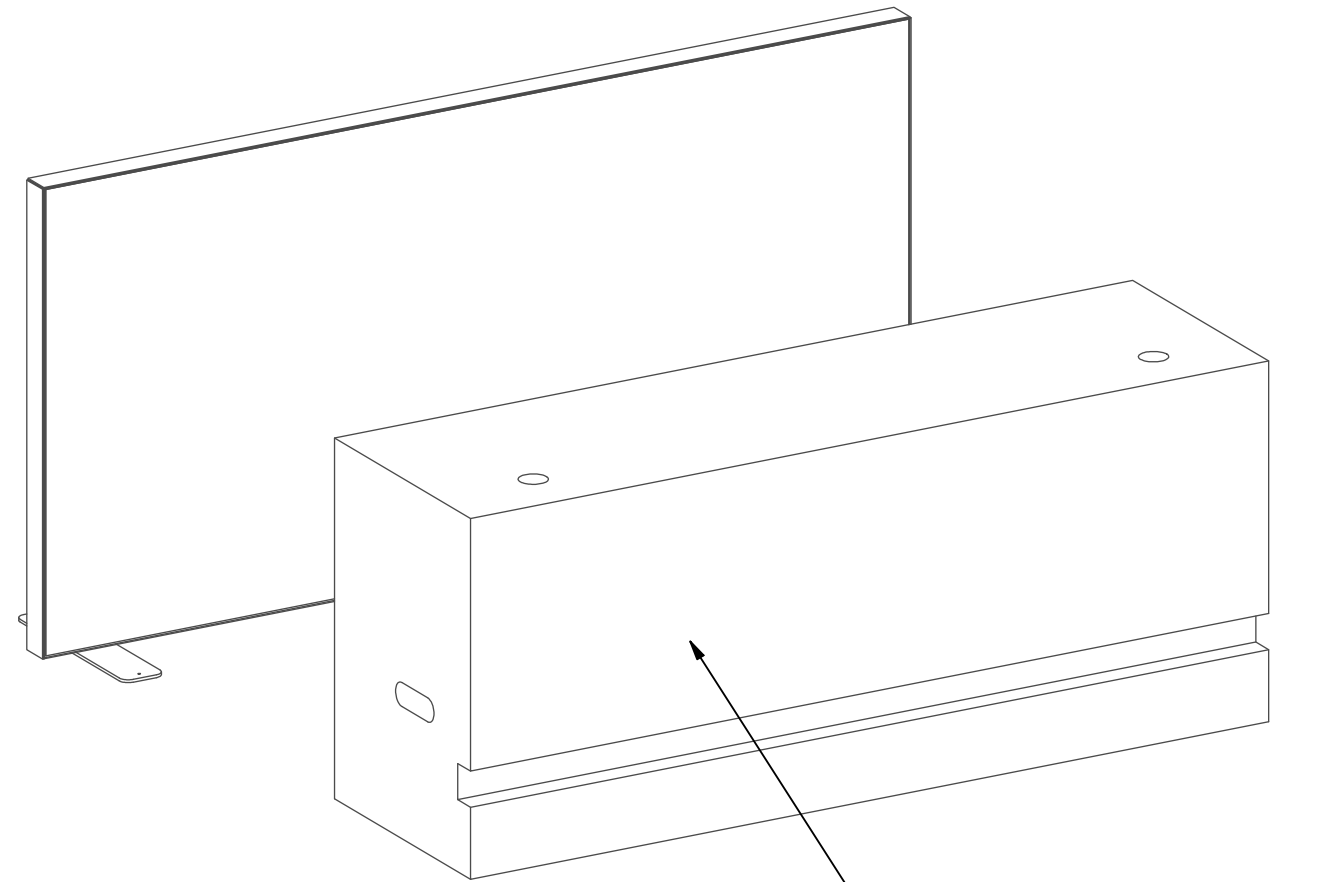

LAMINATE COUNTER

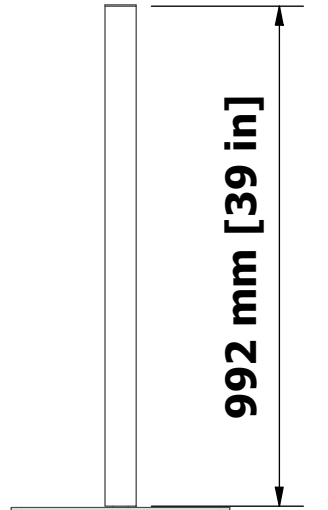
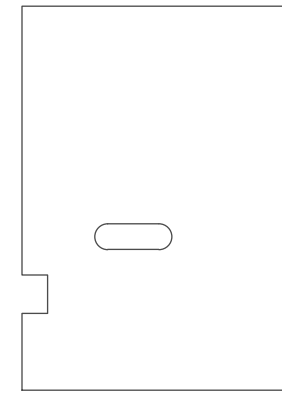

992 mm [39 in]

1984 mm [78 1/8 in]

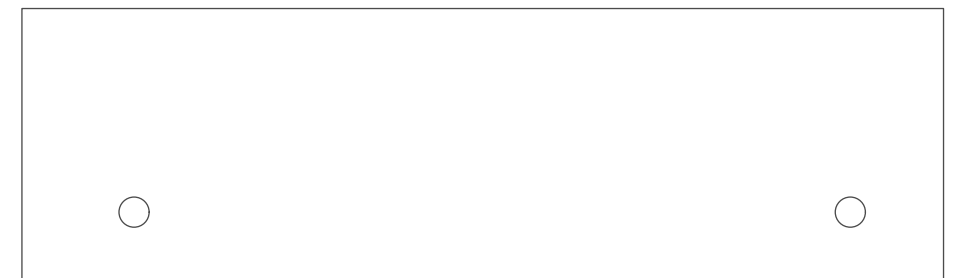
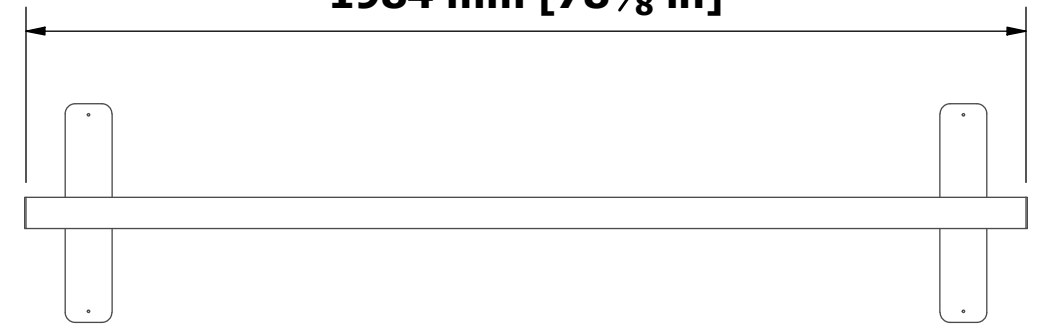

THE EXPO GROUP

PM:	Chris Balak	Date:	5-15-24
Drawn by:	Tom Palladino		
Client:	Neuroscience 2024 Show Mgt Bth		
Project:	CASH REGISTER COUNTER		
Project #	2410003		
Description:	Assembly with floor		1 / 2

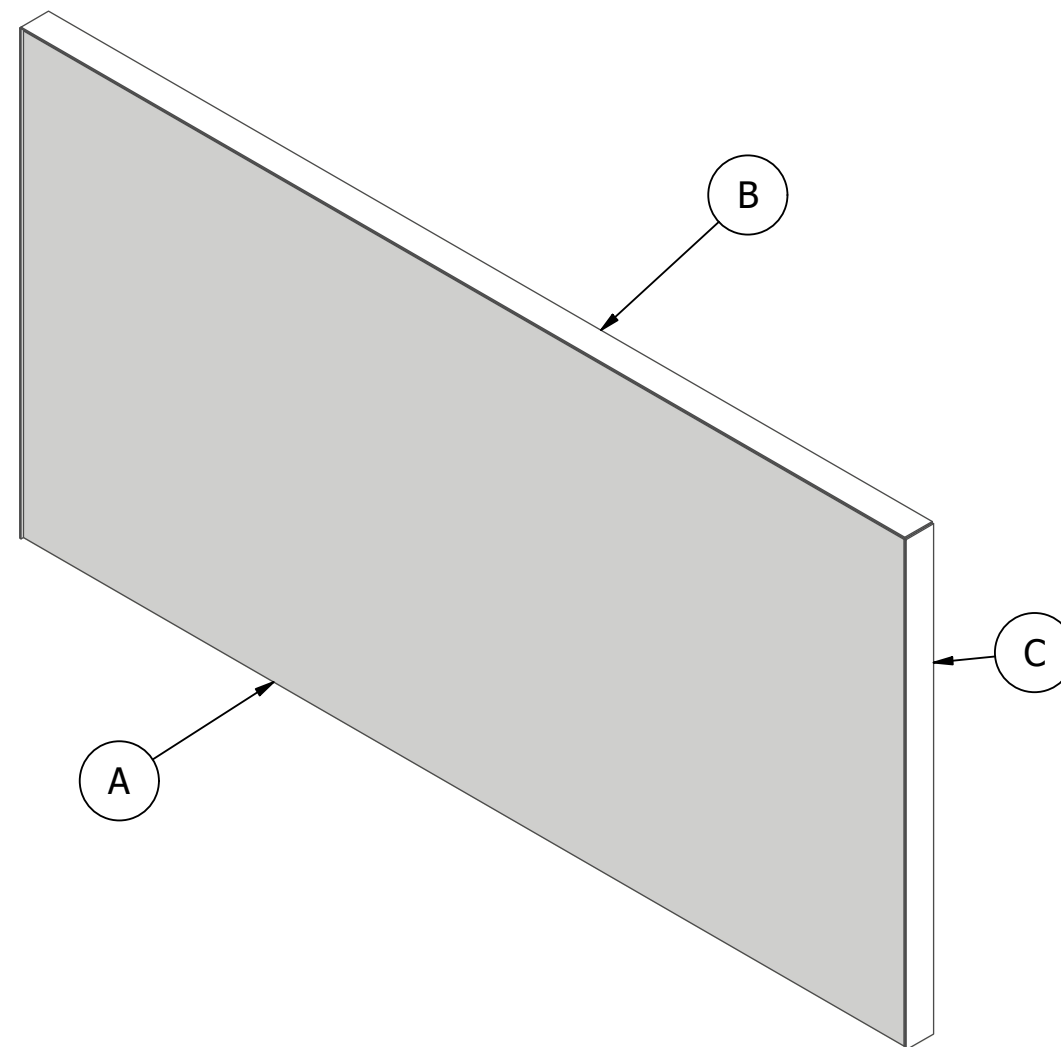
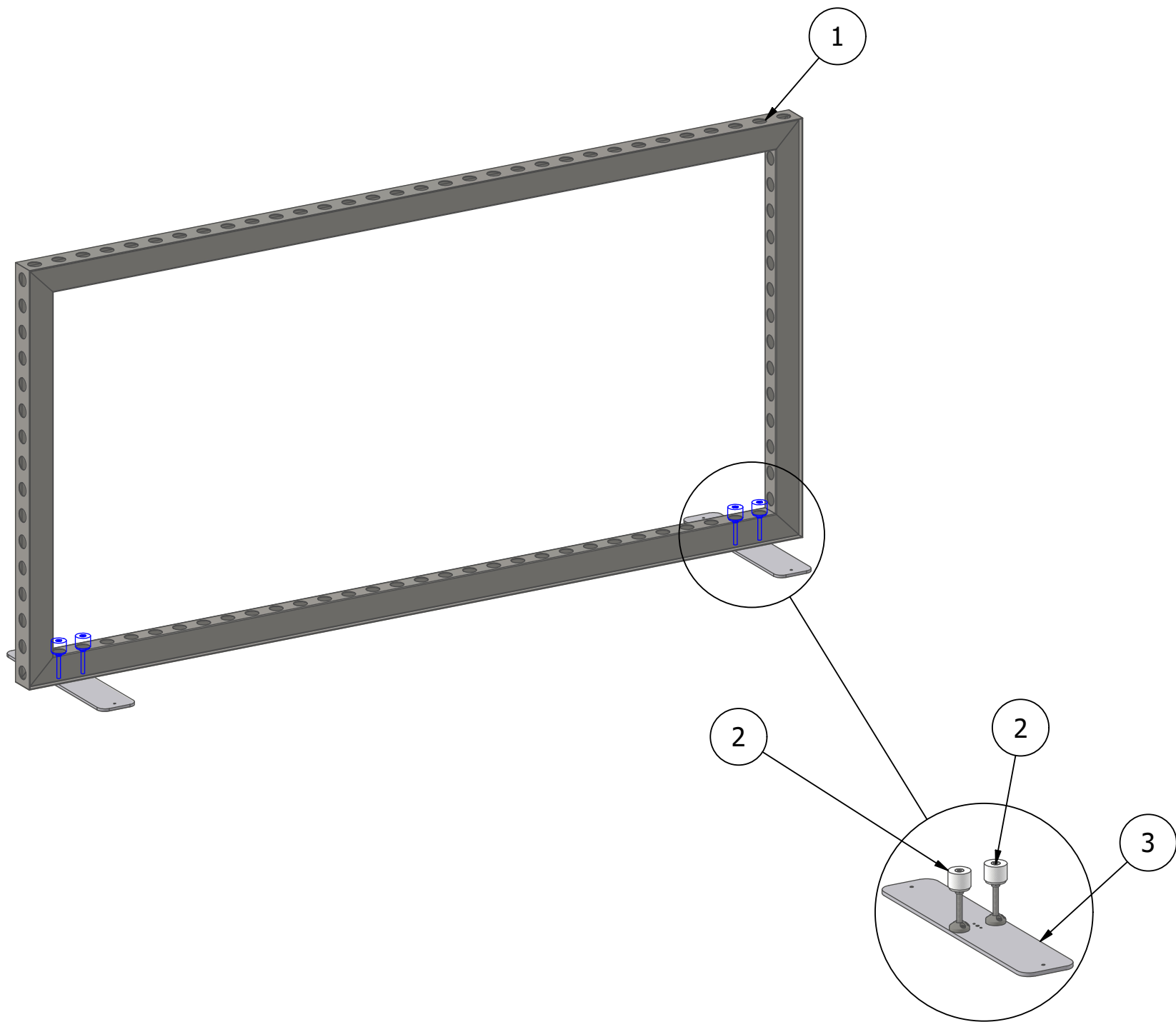

PANEL LIST			
ITEM	QTY	ARTICLE	DESCRIPTION
A	2	Panel for 0992 1984 Frame	3/16" FOAM 38-13/16" x 77-7/8" [0986 X 1978MM]
B	1	Panel Strip for 1984 Frame	1/8" Sintra 2-7/16" x 78-1/8"
C	2	Panel Strip for 0992 Frame	1/8" Sintra 2-7/16" x 39-1/16"

PARTS LIST			
ITEM	QTY	ARTICLE	DESCRIPTION
1	1	606 0992 1984 30	b62 FRAME [0992 X 1984MM] HOLES D30
2	4	901 2048 0066 MkII	TOOLLESS M8 PIN CONNECTOR - MARKII
3	2	901 11 09 2X	BASE PLATE 2X [0093 X 0434MM] RAL 9006 TEC

THE EXPO GROUP

PM: Chris Balak	Date: 5-15-24
Drawn by: Tom Palladino	
Client: Neuroscience 2024 Show Mgt Bth	
Project: CASH REGISTER COUNTER	
Project #: 2410003	
Description: PARTS ASSEMBLY	2 / 2

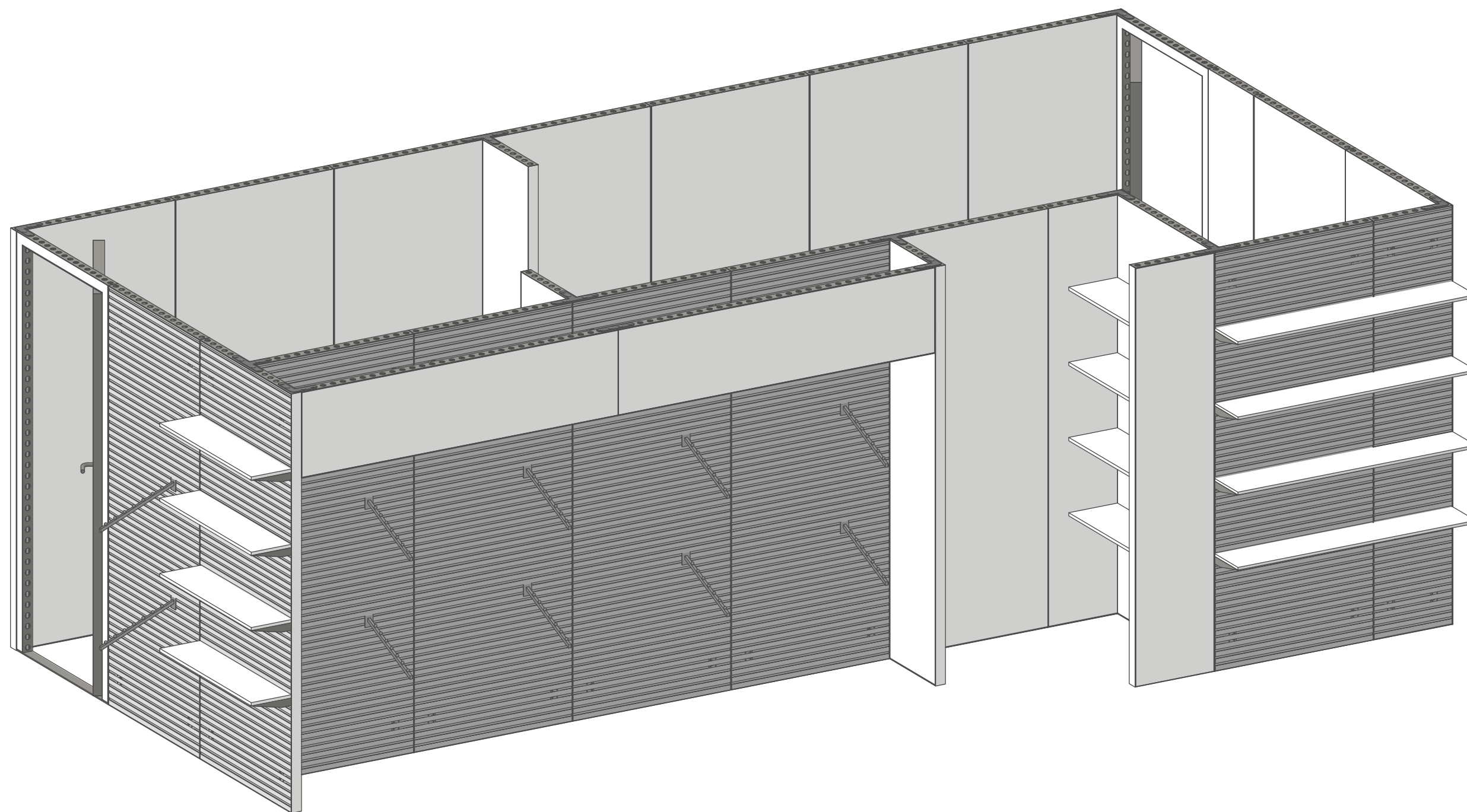

THE EXPO GROUP

PM:	Chris Balak	Date:	5-15-24
Drawn by:	Tom Palladino		
Client:	Neuroscience 2024, Show Mgt Bth		
Project:	OFFICE		
Project #	2410003		
Description:	Assembly with floor		1/4

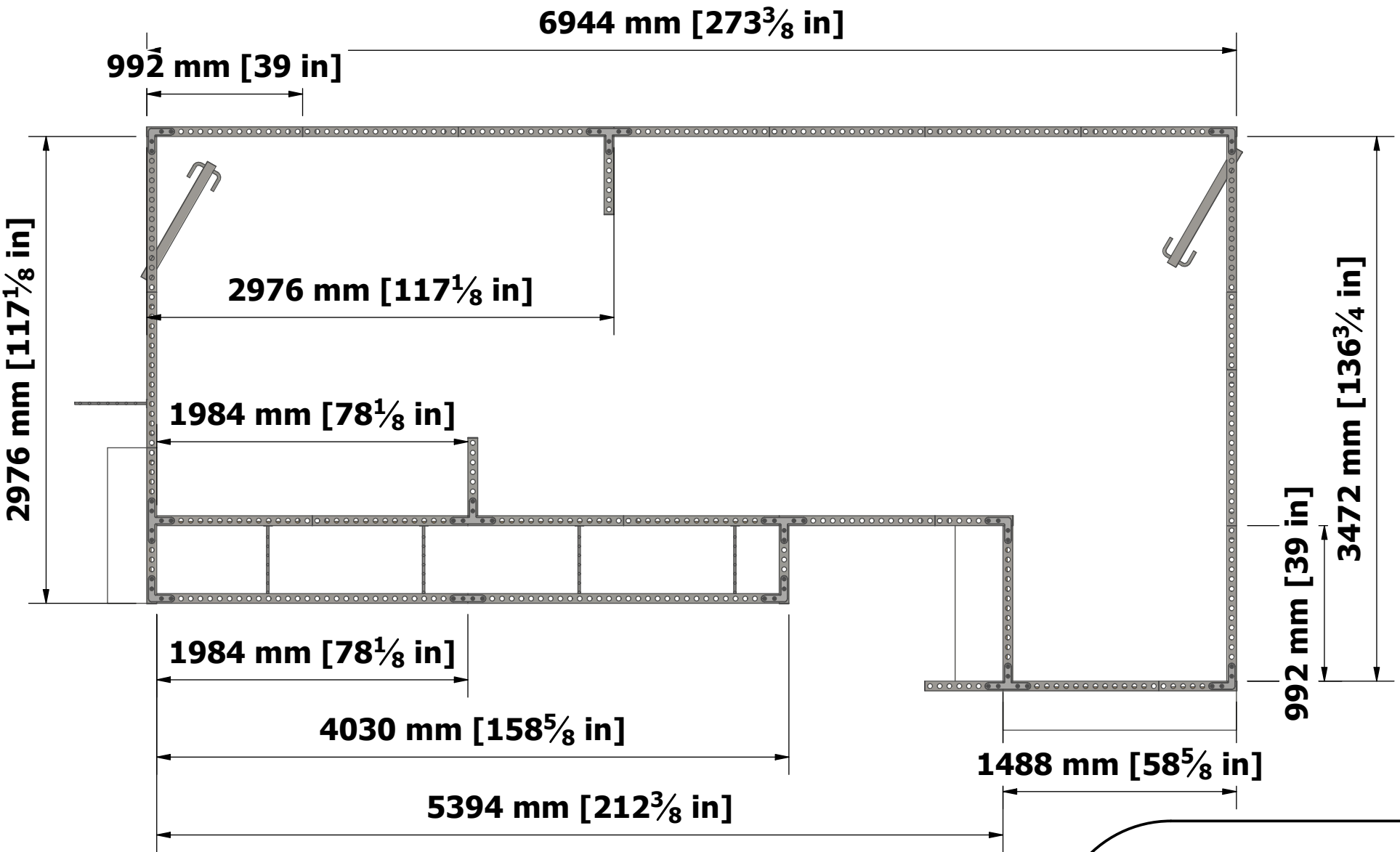
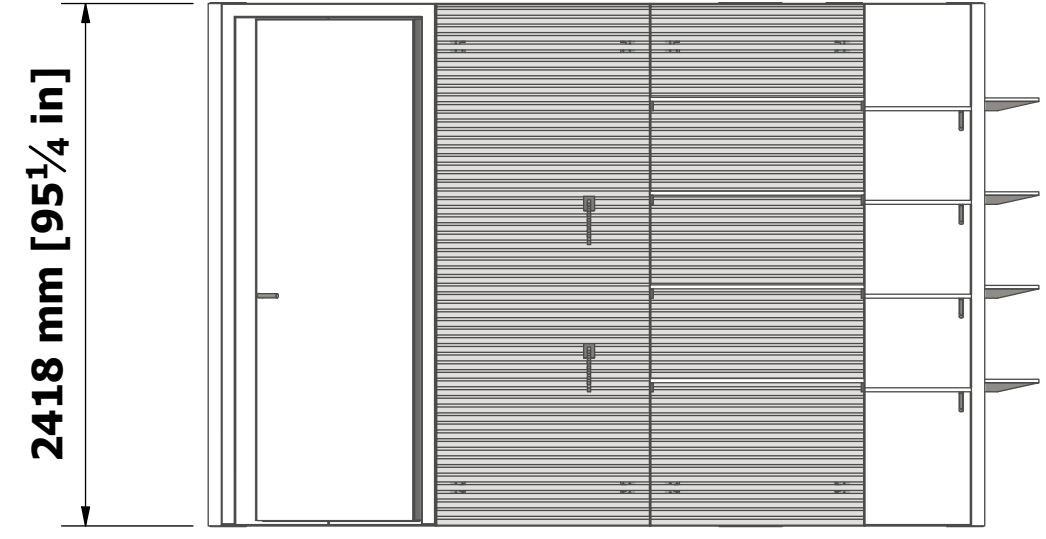
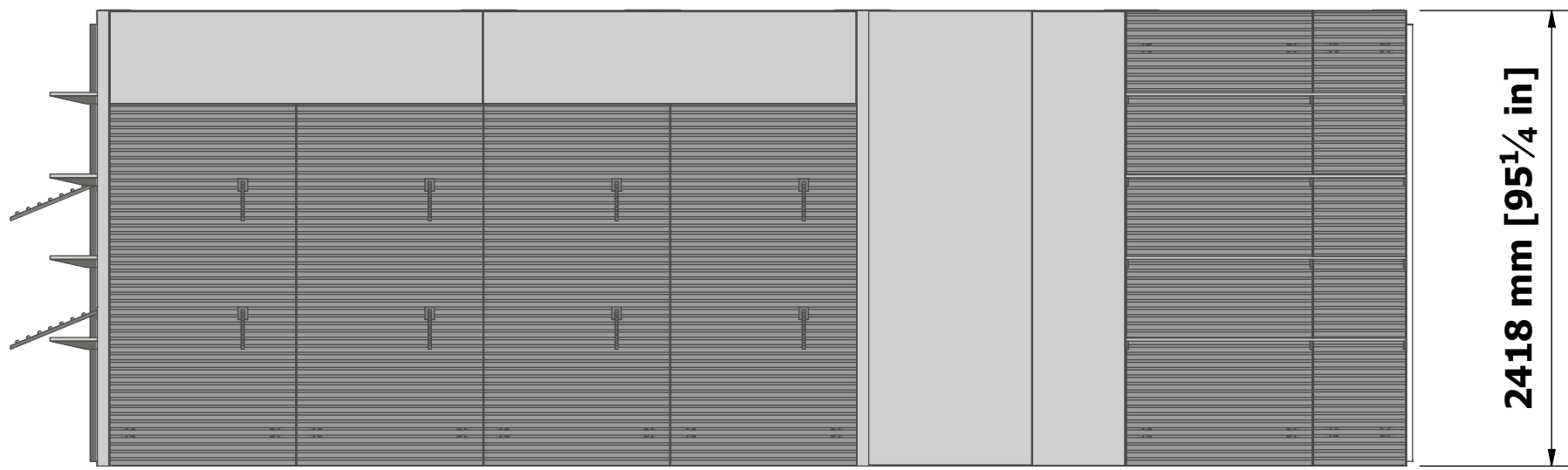

THE EXPO GROUP

PM:	Chris Balak	Date:	5-15-24
Drawn by:	Tom Palladino		
Client:	Neuroscience 2024, Show Mgt Bth		
Project:	OFFICE		
Project #	2410003		
Description:	Assembly with floor		2 / 4

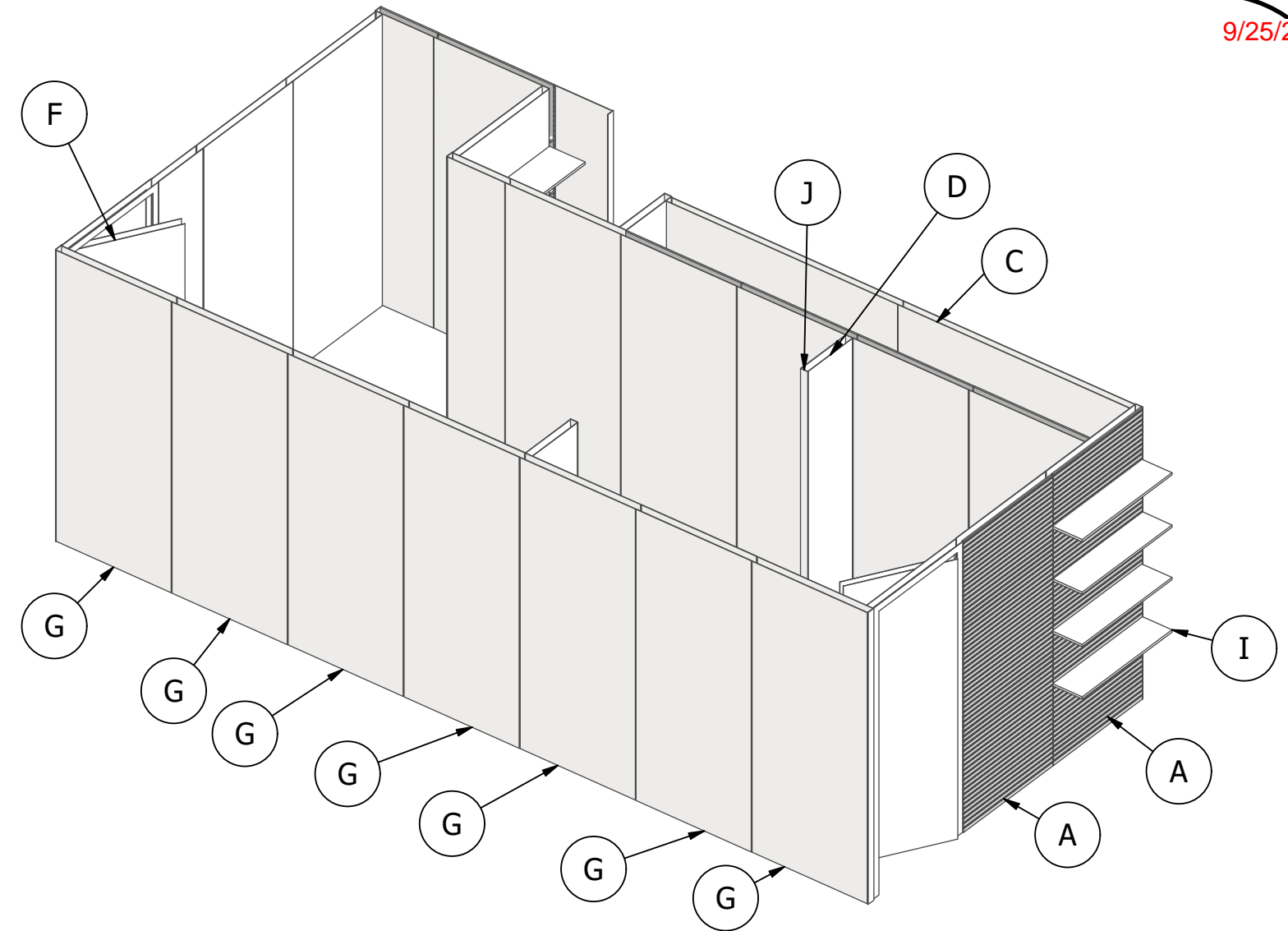
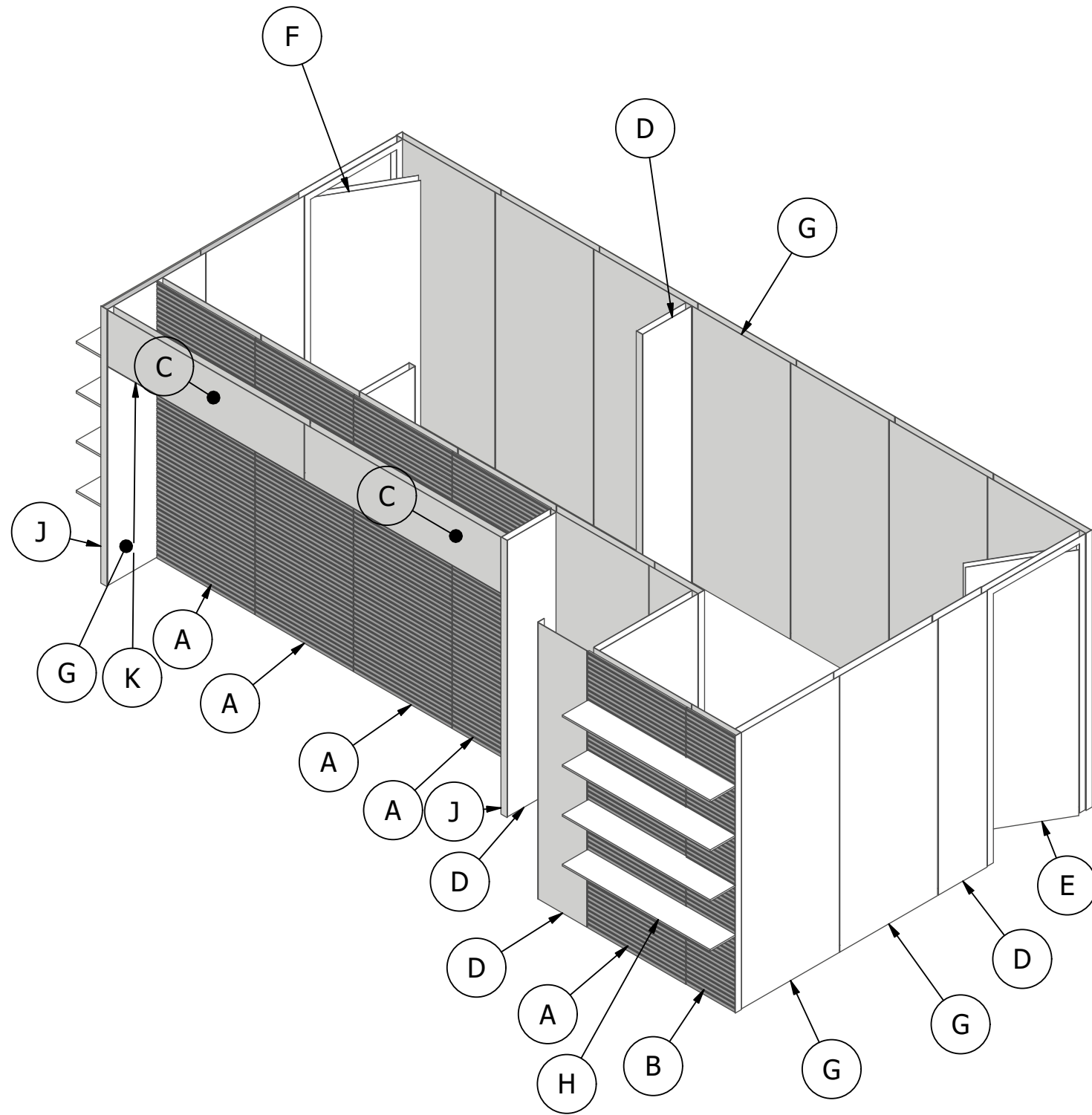

PARTS LIST

ITEM	QTY	ARTICLE	DESCRIPTION
A	7	Panel - Slat Wall	986mm x 2412mm [38-13/16" x 94-15/16"]
B	1	Slatwall for 0496 2418 Frame	986mm x 2412mm [38-13/16" x 94-15/16"]
C	4	Panel for 0496 1984 Frame	3/16" FOAM 19-1/4" x 77-7/8" [0490 X 1978MM]
D	12	Panel for 0496 2418 Frame	3/16" FOAM 19-1/4" x 94-15/16" [0490 X 2412MM]
E	2	Panel for 0992 2418 Door Frame	3/16" FOAM FOR b62 DOOR MKII 33-1/16" x 91-1/8" [0992 X 2418]
F	2	Panel for 0992 2418 Door Frame	3/16" FOAM FOR b62 DOOR MKII 33-1/16" x 91-1/8" [0992 X 2418]
G	29	Panel for 0992 2418 Frame	3/16" FOAM 38-13/16 x 94-15/16" [986 x 2412MM]
H	4	Shelf 1488 x 305	Melamine 58-9/16" x 12" [1488 x 305mm]
I	8	Shelf 992 X 305	Melamine 39"x12"
J	9	Panel Strip for 2418 Frame	1/8" Sintra 2-7/16" x 95-3/16"
K	2	Panel Strip for 1984 Frame	1/8" Sintra 2-7/16" x 78-1/8"

THE EXPO GROUP

PM:	Chris Balak	Date:	5-15-24
Drawn by:	Tom Palladino		
Client:	Neuroscience 2024, Show Mgt Bth		
Project:	OFFICE		
Project #	2410003		
Description:	PANELS		

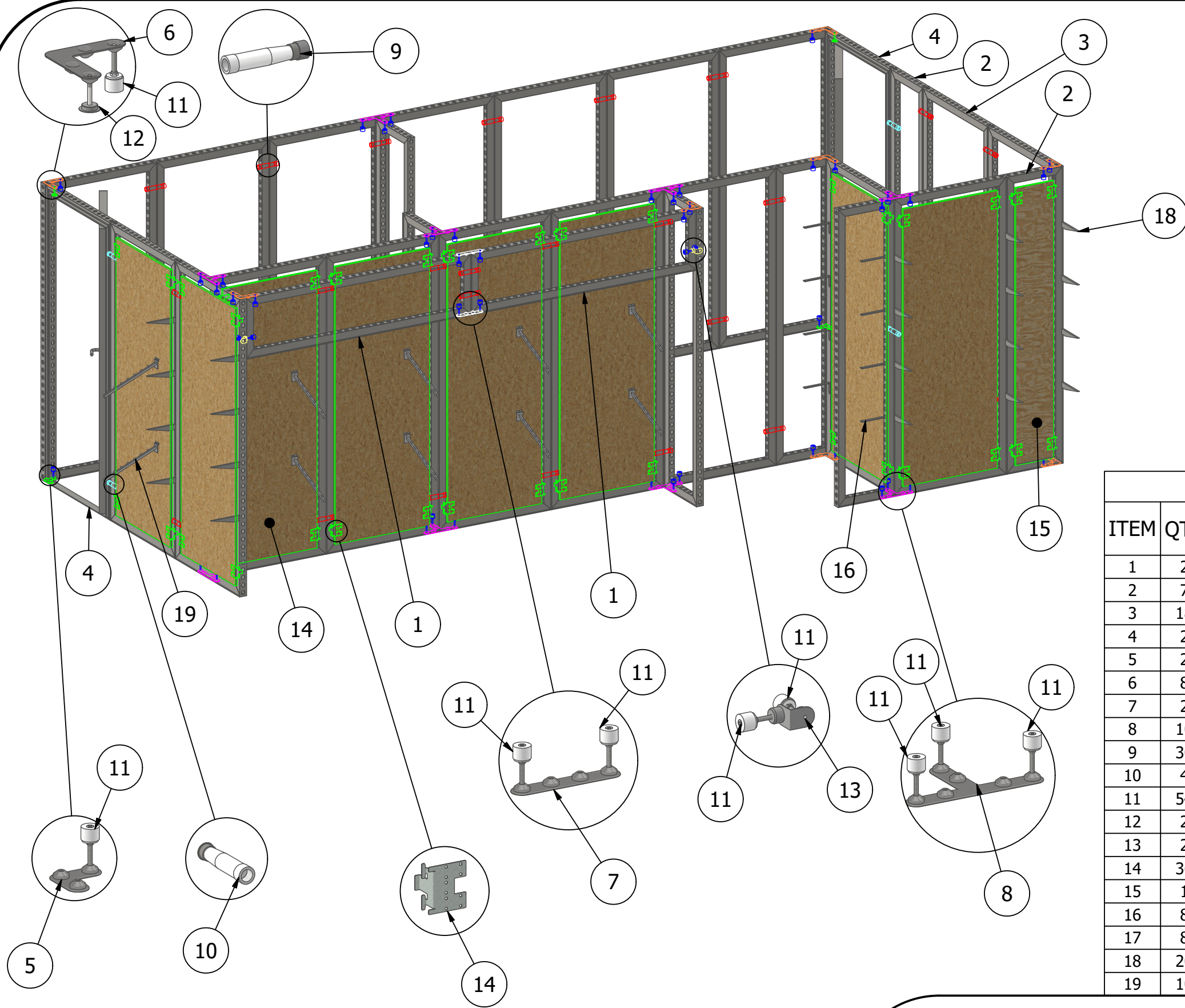

PARTS LIST

ITEM	QTY	ARTICLE	DESCRIPTION
1	2	606 0496 1984 30	b62 FRAME [0496 X 1984MM] HOLES D30
2	7	606 0496 2418 30	b62 FRAME [0496 X 2418MM] HOLES D30
3	18	606 0992 2418 30	b62 FRAME [0992 X 2418MM] HOLES D30
4	2	617 0992 2418 P	b62 PIVOT DOOR d62 [0992 X 2418MM]
5	2	901 28 0331 E	3 PIN 90° D30 ECO
6	8	901 28 0341 E	4 PIN 90° D30 ECO
7	2	901 28 0342 E	4 PIN 180° D30 ECO
8	10	901 28 0364 E	T6 PIN 90° D30 ECO
9	30	901 2025 0132 POM	TOOLLESS CONNECTOR D30
10	4	901 2041 0060 E	TOOLLESS DOOR CONNECTOR D30
11	54	901 2048 0066 MkII	TOOLLESS M8 PIN CONNECTOR - MARKII
12	2	901 2049 0066 INOX	1MM M8 PIN CONNECTOR D30
13	2	901 28 0222 INOX	b62 90° CONNECTION BASE D30
14	36	901 3703 b62 GALVA _ Single	b62 UNIVERSAL BRACKET
15	1	Full Sheet for 496 x 2418mm Frame11	Plywood for Slatwall
16	8	MOUNTED SHELF BRACKET	Mounted Shelf Bracket
17	8	Plywood Insert for 992 2418 slat wall	Plywood for Slatwall
18	20	SHELF BRACKET1	Slat Wall Shelf Bracket
19	10	WATER FALL DISPLAY SHELF	Slat Wall Waterfall Bracket

THE EXPO GROUP

PM:	Chris Balak	Date:	5-15-24
Drawn by:	Tom Palladino		
Client:	Neuroscience 2024, Show Mgt Bth		
Project:	OFFICE		
Project #	2410003		
Description:	PARTS ASSEMBLY		4 / 4

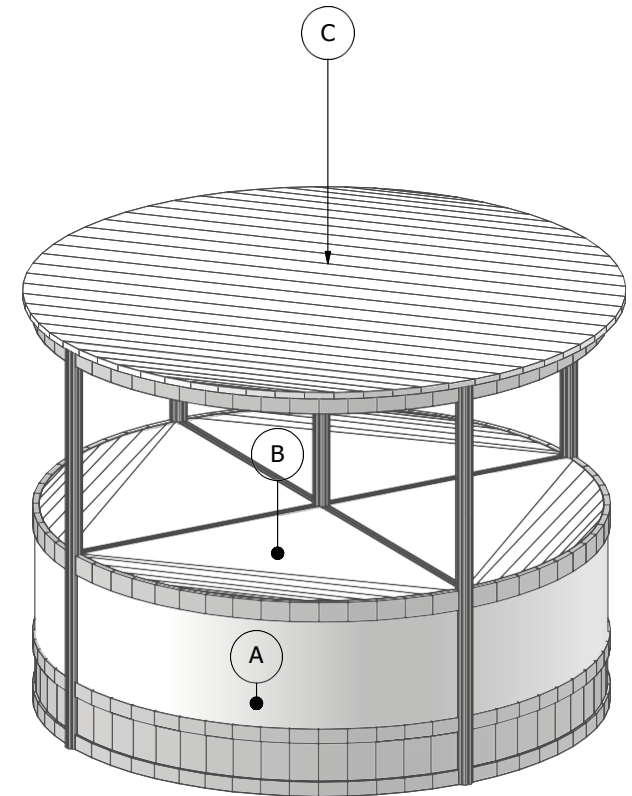
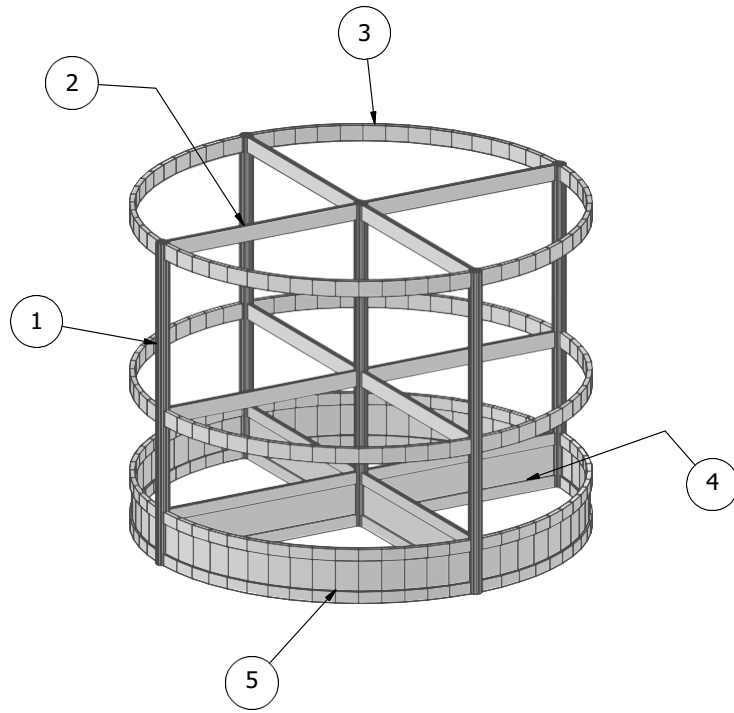

QTY:2

PARTS LIST			
ITEM	QTY	ARTICLE	DESCRIPTION
1	5	Upright S108 1047	41-1/4 in with Feet
2	10	Beam 50_660mm	Z 420 (1/2 Meter DIA)
3	8	Curve Beam 50_1060mm	Z 400 (1 Meter)
4	4	Beam 175_660mm	Z 508 (1/2 Meter DIA)
5	4	Curve Beam 175_1060mm	Z 508 (1 Meter)
A	4	Panel [1073 x 297mm]	42-1/4" x 11-3/4"
B	4	Countertop [692 x 692mm]	27-1/4" x 27-1/4"
C	1	Countertop [1431 x 1431mm]	56-5/16" x 56-5/16"

THE EXPO GROUP

PM:	Date:
Drawn by: Victor Garcia	12/14/2022
Client:	
Project: Retail Shops 3	
Project #	
Description: Callouts	

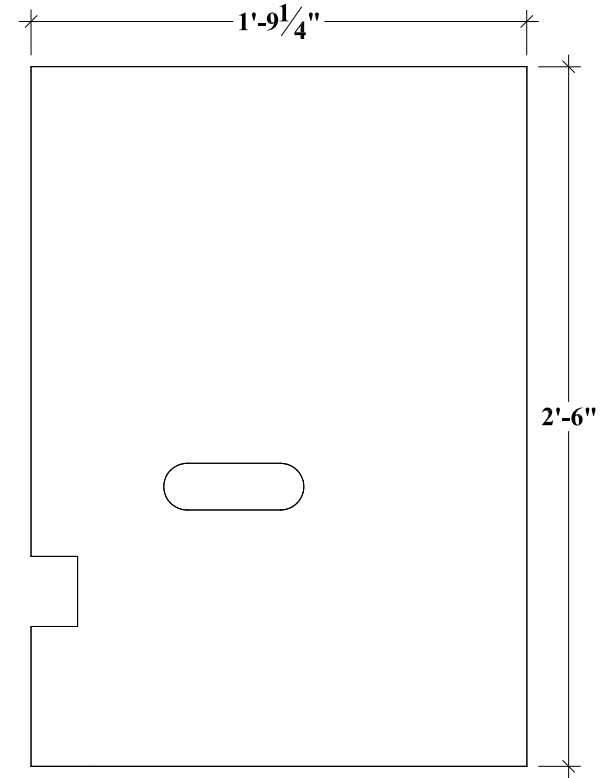
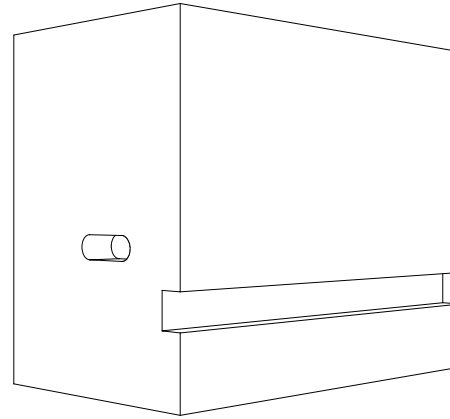
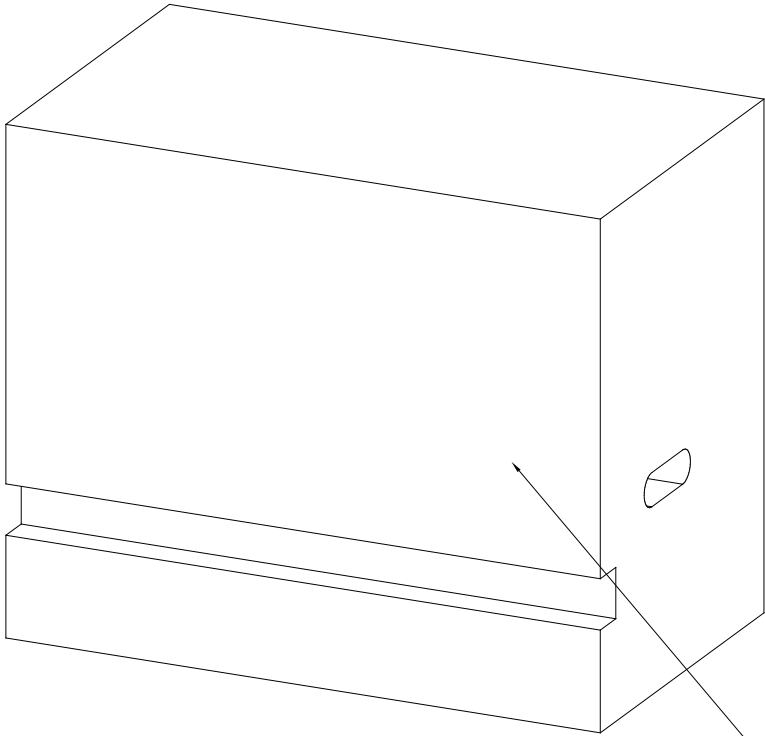

GRAPHIC SIZE:
36"X21"

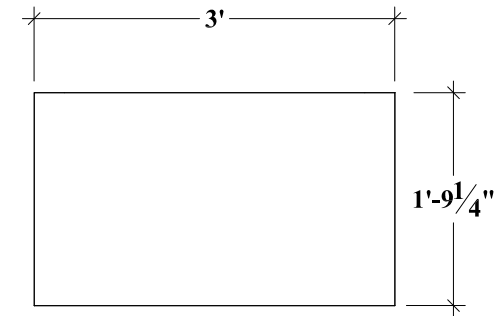
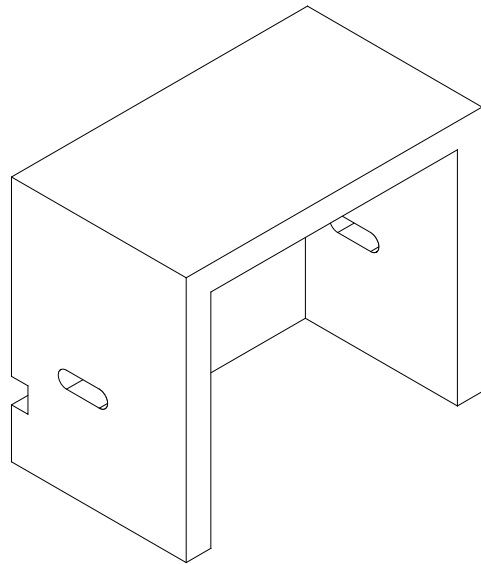

THE EXPO GROUP
theexpogroup.com | 972.580.9000

Project Manager:	Date: 12/16/21
Drawn by:	
Client:	
Project: TEG SMART 3 FT COUNTER ADA NEW.dwg	
Quotation/Order:	
Description:	1 / 1

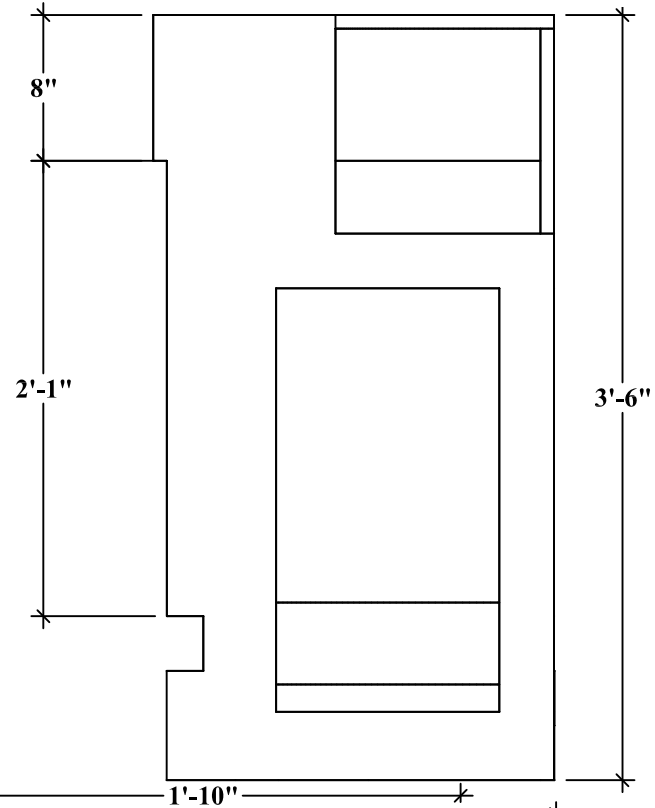
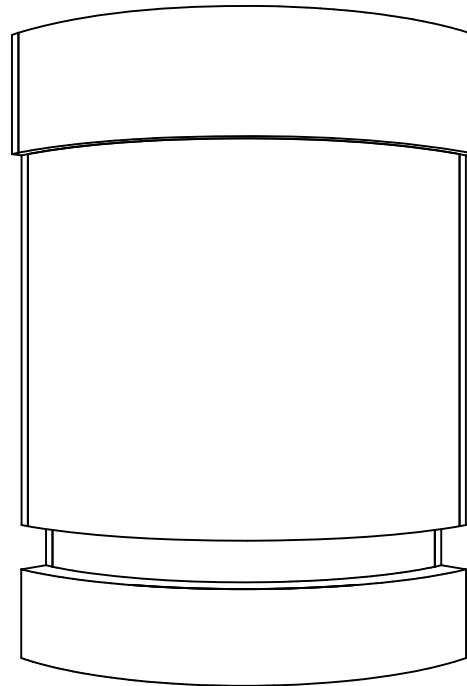
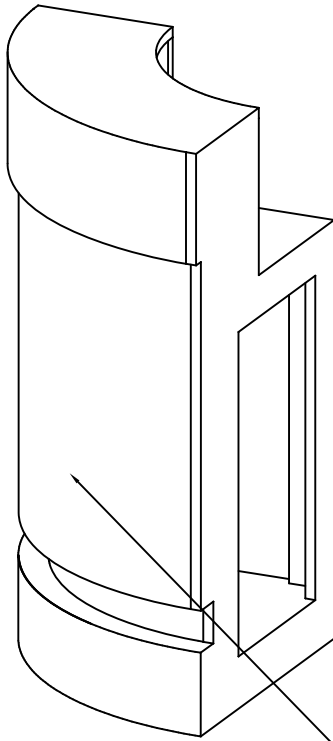

GRAPHIC PANEL SIZE:
32"X25"

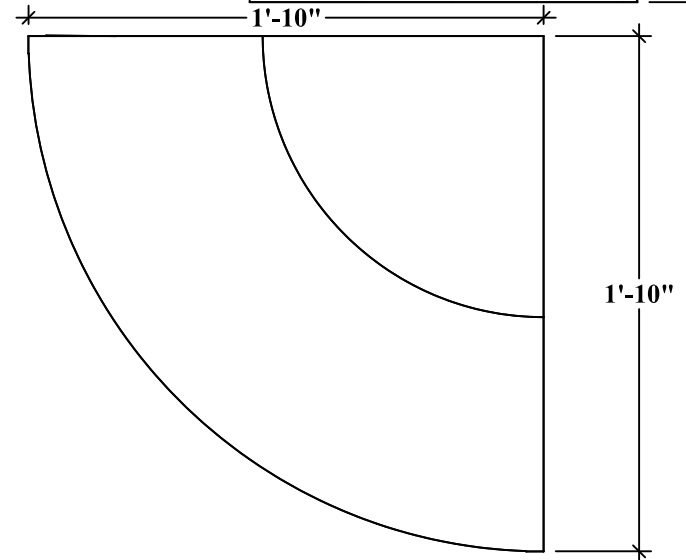
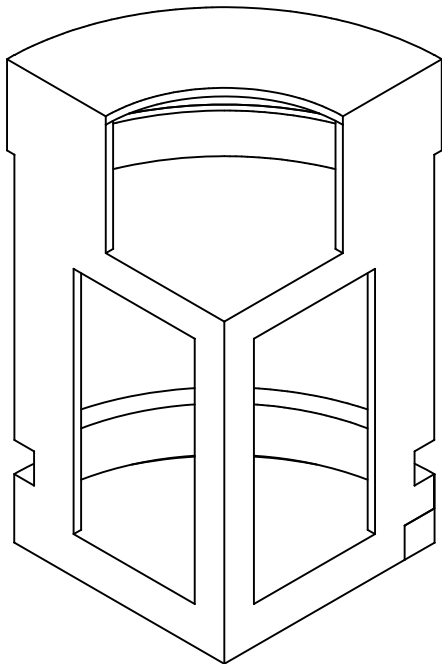

THE EXPO GROUP
theexpogroup.com | 972.580.9000

Project Manager:	Date: 12/16/21
Drawn by:	
Client:	
Project: TEG SMART 90 CURVED COUNTER CTR.dwg	
Quotation/Order:	
Description:	1 / 1

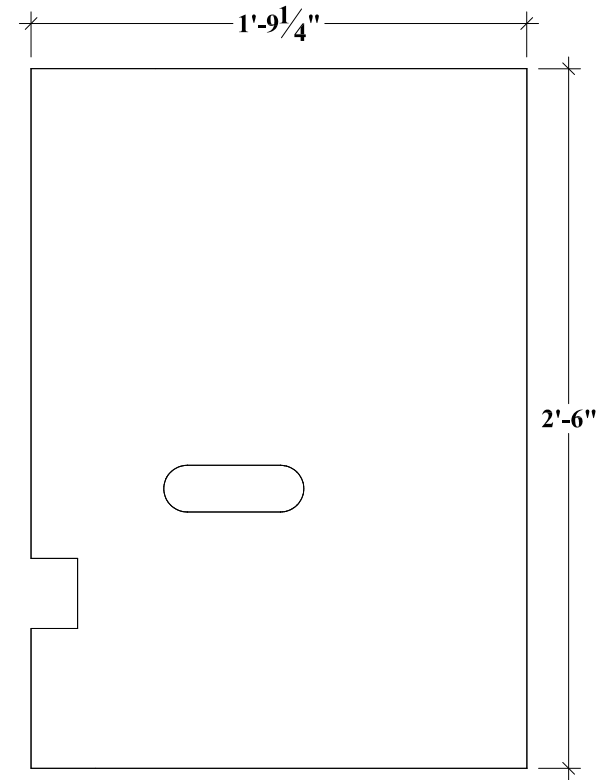
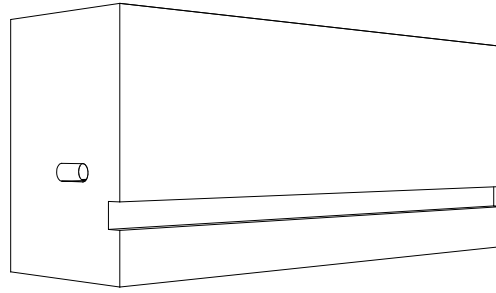
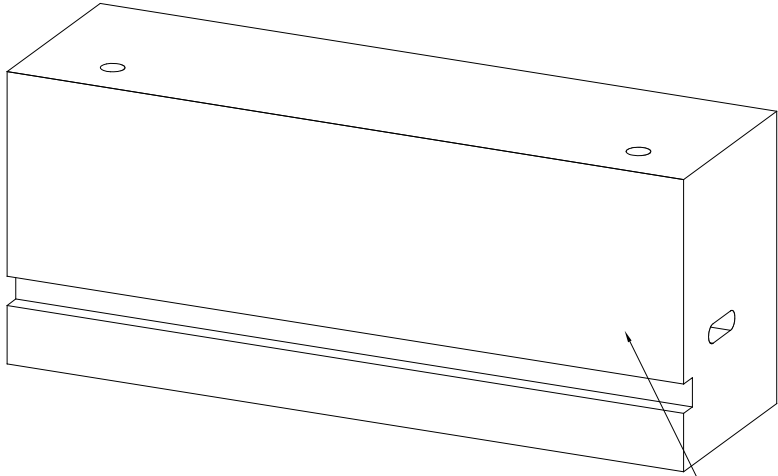

GRAPHIC SIZE:
72"X21"

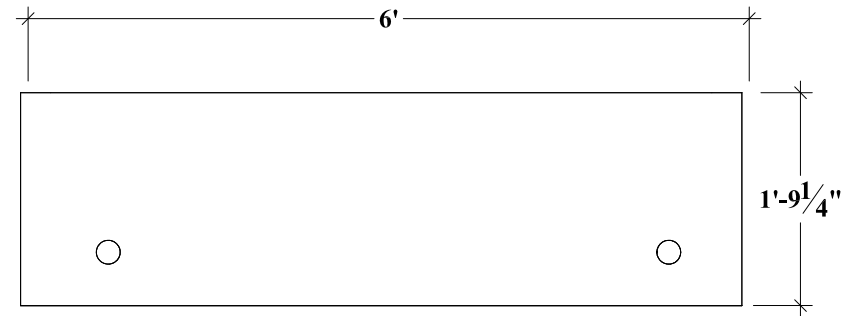
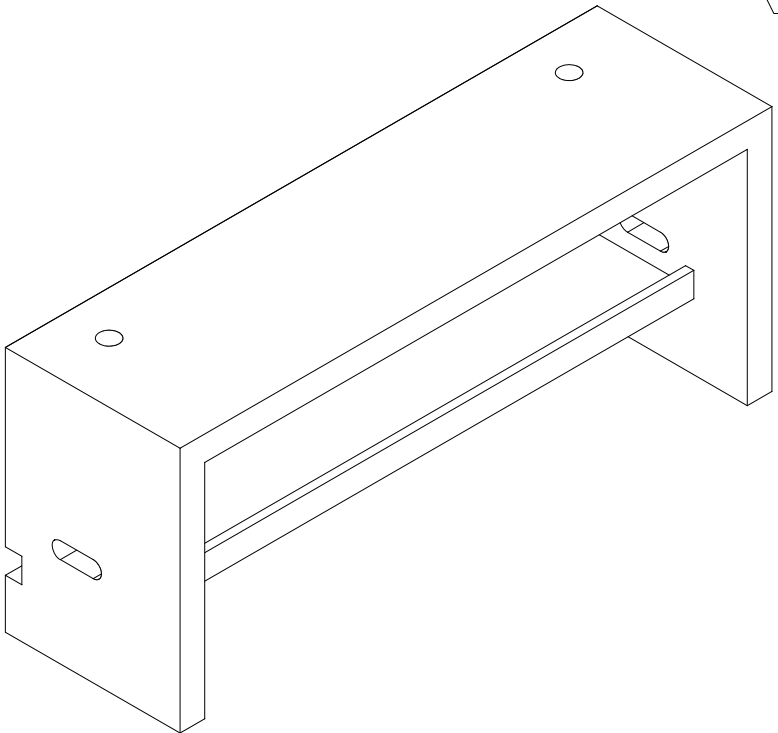

THE EXPO GROUP
theexpogroup.com | 972.580.9000

Project Manager:	Date: 12/16/21
Drawn by:	
Client:	
Project: TEG SMART COUNTER ADA NEW.dwg	
Quotation/Order:	
Description:	1 / 1